



# San Bernardino City Unified School District Facilities Management Department

## Wong Elementary School

### New Campus (C01)



#### Project Information

<b>Seats</b>	823
<b>General Classrooms</b>	28
<b>Site</b>	15.5 acres
<b>Construction</b>	54,979 sq.ft.
<b>Owner Representative</b>	
<b>Construction Manager</b>	Neff
<b>Architect</b>	HMC
<b>Project Cost Estimate</b>	\$35,145,313.00

#### Schedule

<b>Construction Start</b>	
<b>Construction Finish</b>	

The project is new school construction, including the development of the entire site and new building construction. The scope of the new structures consist of three (3) new buildings, 28 general classrooms with restrooms, lunch shelters, and one (1) Administration Building, Child development classrooms with restrooms and playground, and special education classrooms with restrooms.

#### Vicinity Map

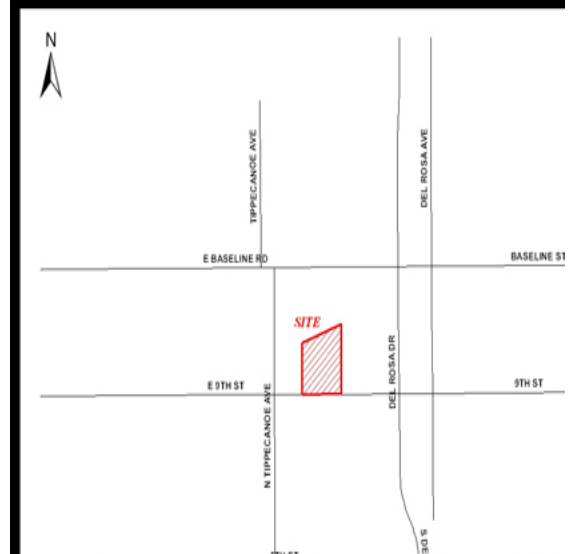

To view photos of this project, or to learn more about SBCUSD Facilities programs, please visit us at <http://www.sbcusdfacilities.com>.